

Made in Holland

PITT
COOKING

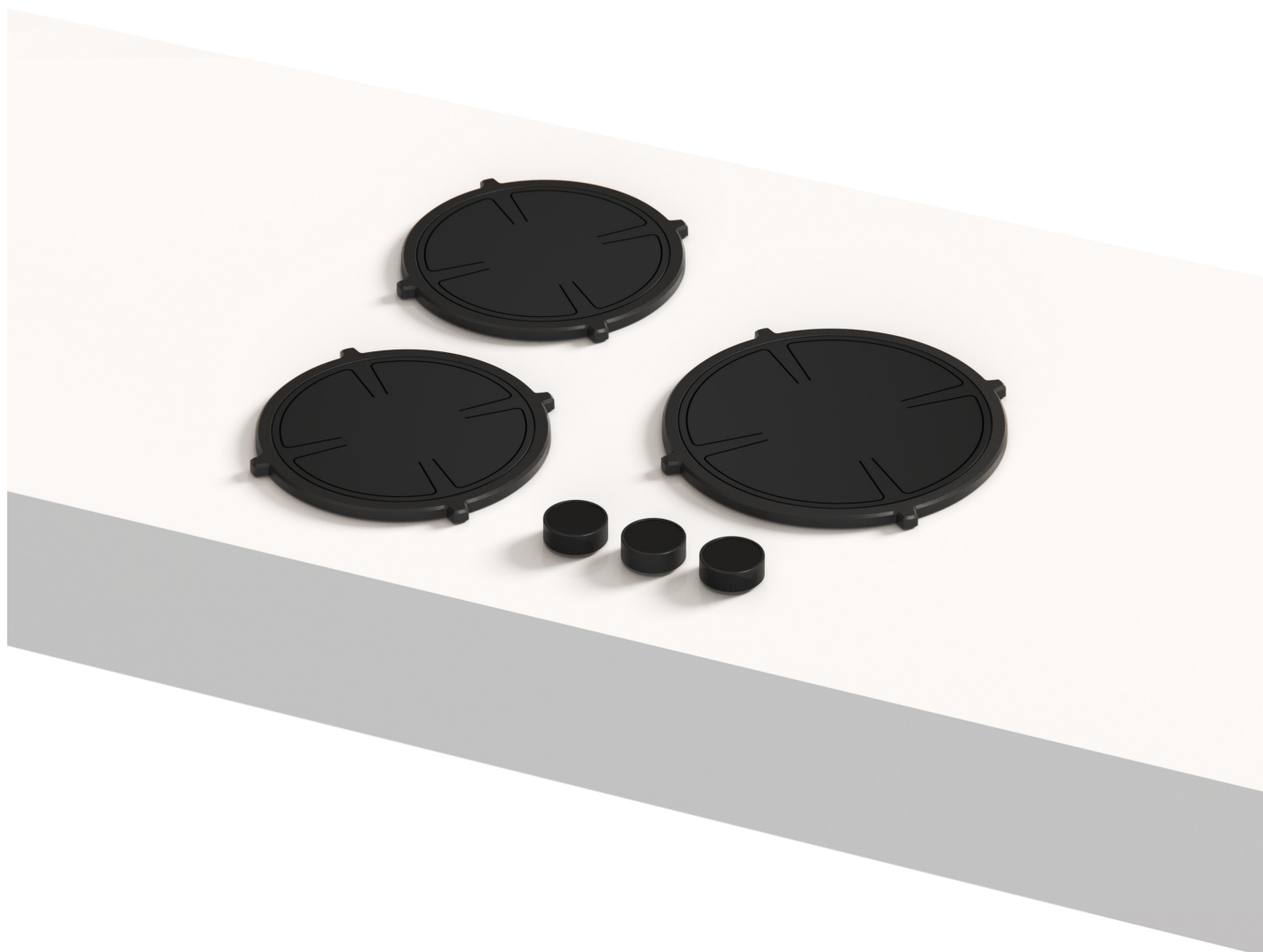

Induction
Capital-I
Top Side

Exploded view

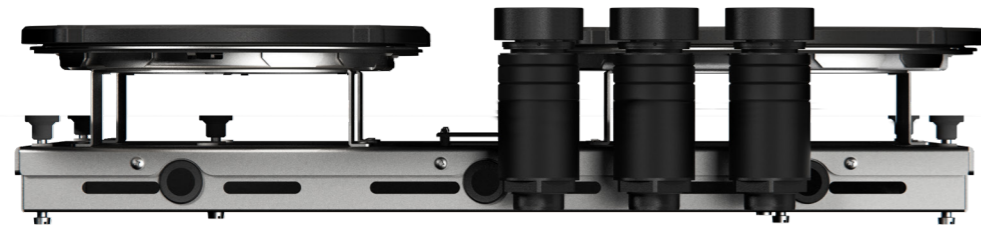

1. **Decorative ring small**
PVD COATED ALUMINUM

2. **Decorative ring large**
PVD COATED ALUMINUM

3. **Induction zone small**
PVD COATED ALUMINUM/ CERAMIC GLASS

4. **Induction zone large**
PVD COATED ALUMINUM/ CERAMIC GLASS

5. **Control knob**
ALUMINUM/GLASS

6. **Cassette**
ALUMINUM

Induction zones

Small zone

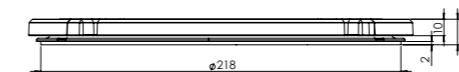
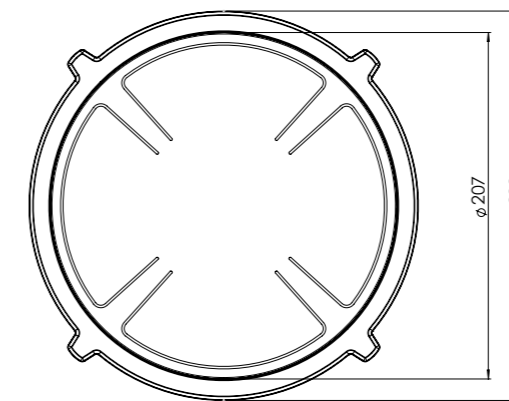

SMALL ZONE

NOM. POWER
1400 Watt
MIN. DIAM. PAN
110 mm

MAX. POWER
2100 Watt
MAX. DIAM. PAN
210 mm

Large zone

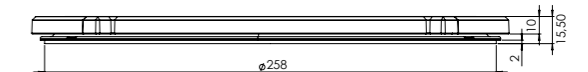
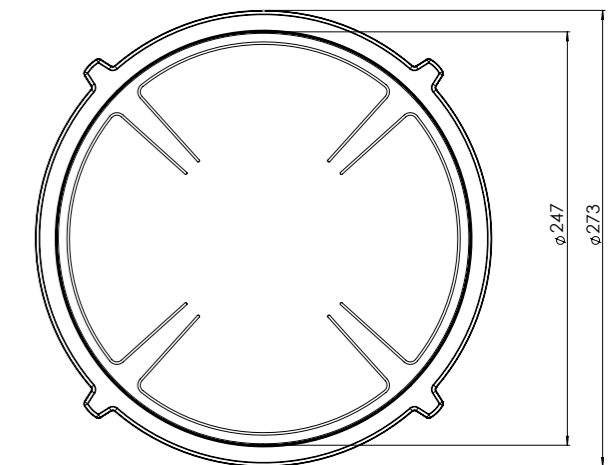

LARGE ZONE

NOM. POWER
2300 Watt
MIN. DIAM. PAN
110 mm

MAX. POWER
3000 Watt
MAX. DIAM. PAN
250 mm

Control knob

3D-visualization of Top Side knob



3D-visualization Front Side knob



Dimensions control knob

Front view

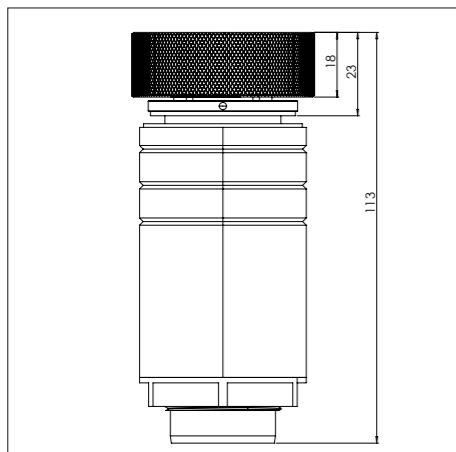

Top view

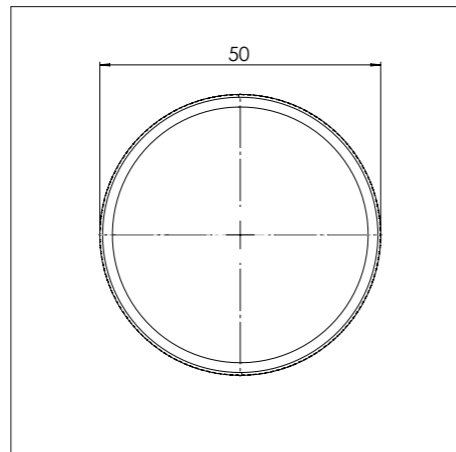

Control knob

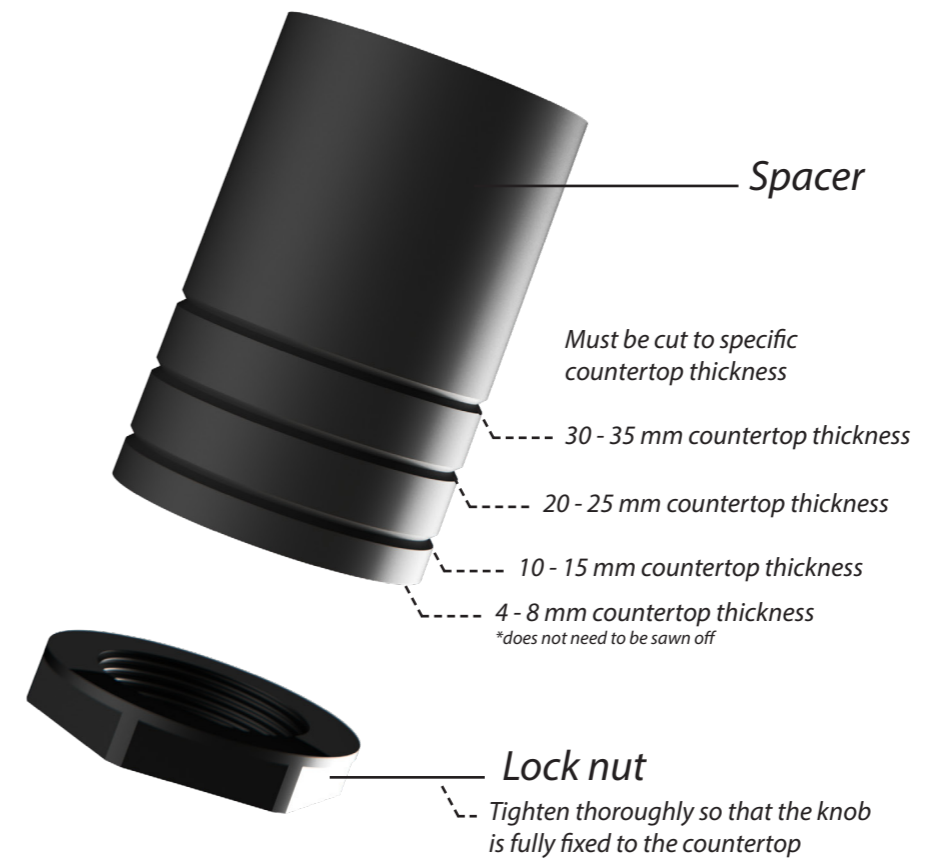
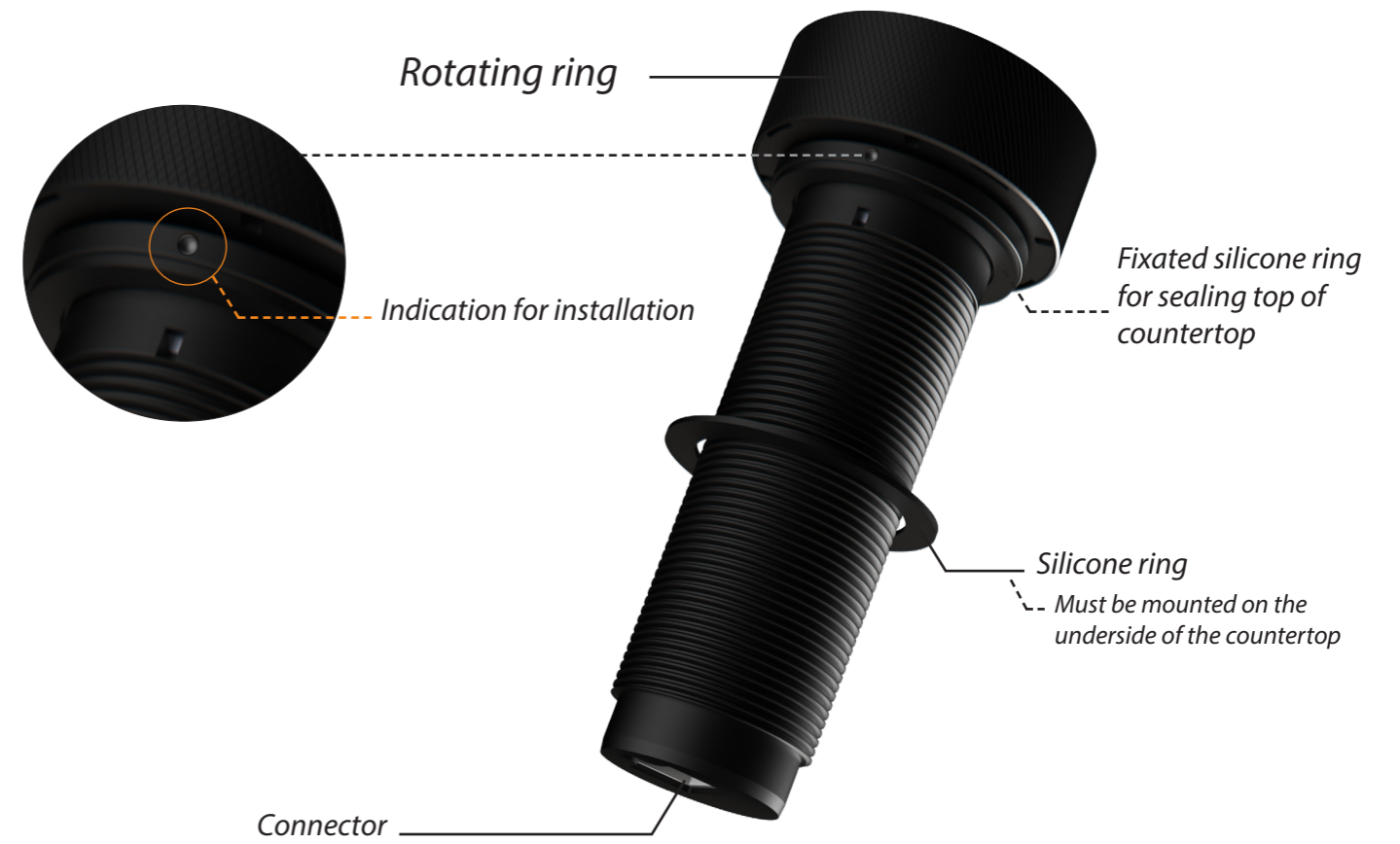

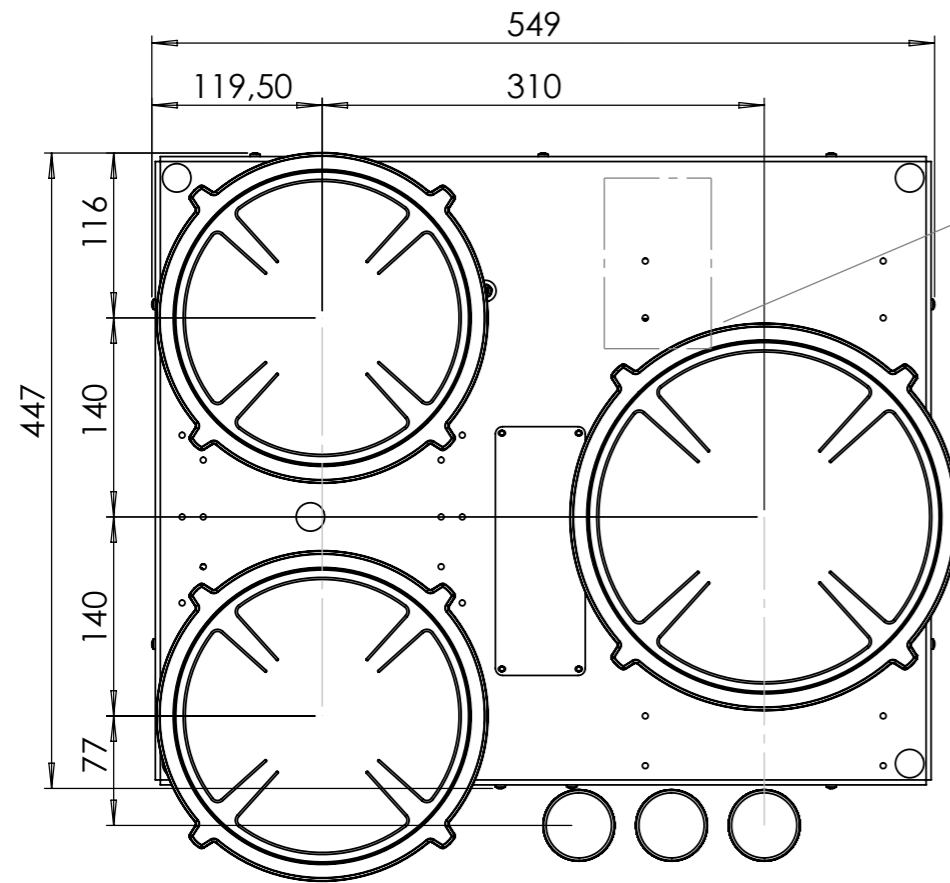

Bovenaanzicht / Top view

Elektrapunt/
Electrical connection

Elektrapunt/
Electrical connection

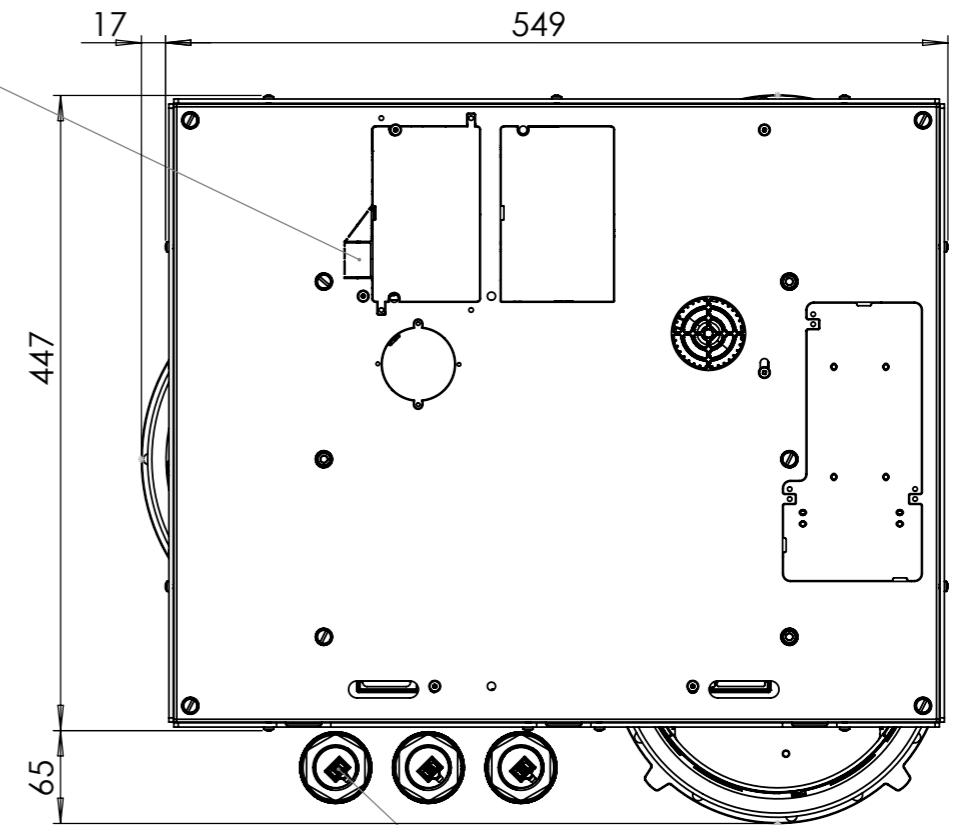

Onderaanzicht / Bottom view

Connector knop/
Connector knob

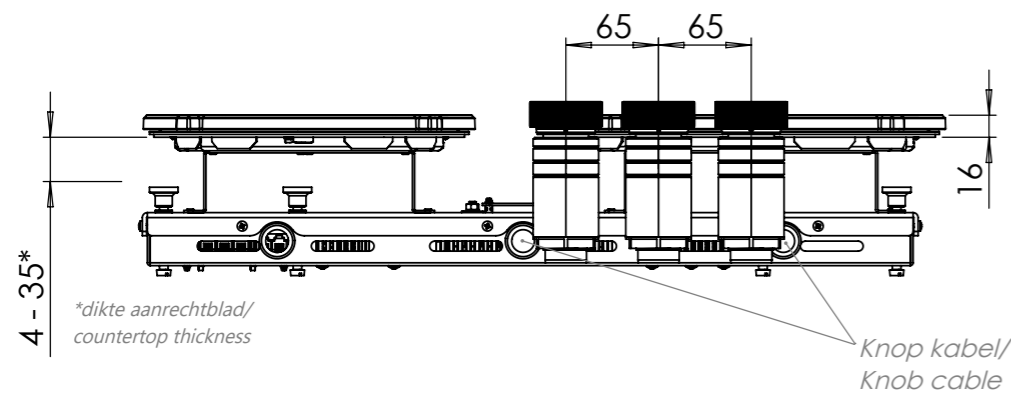

Vooraanzicht / Front view

Knop kabel/
Knob cable

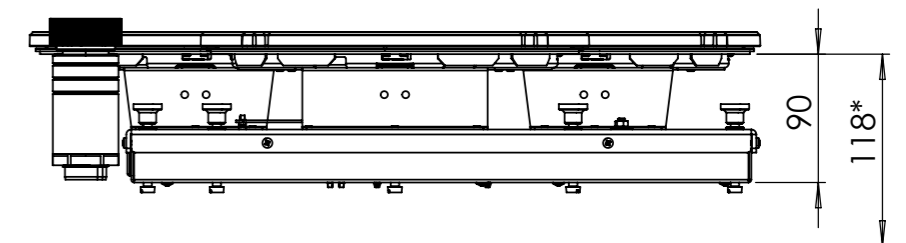

Zijaanzicht / Side view

*Inclusief ondersteuningsset/
Including support bar

Hole pattern

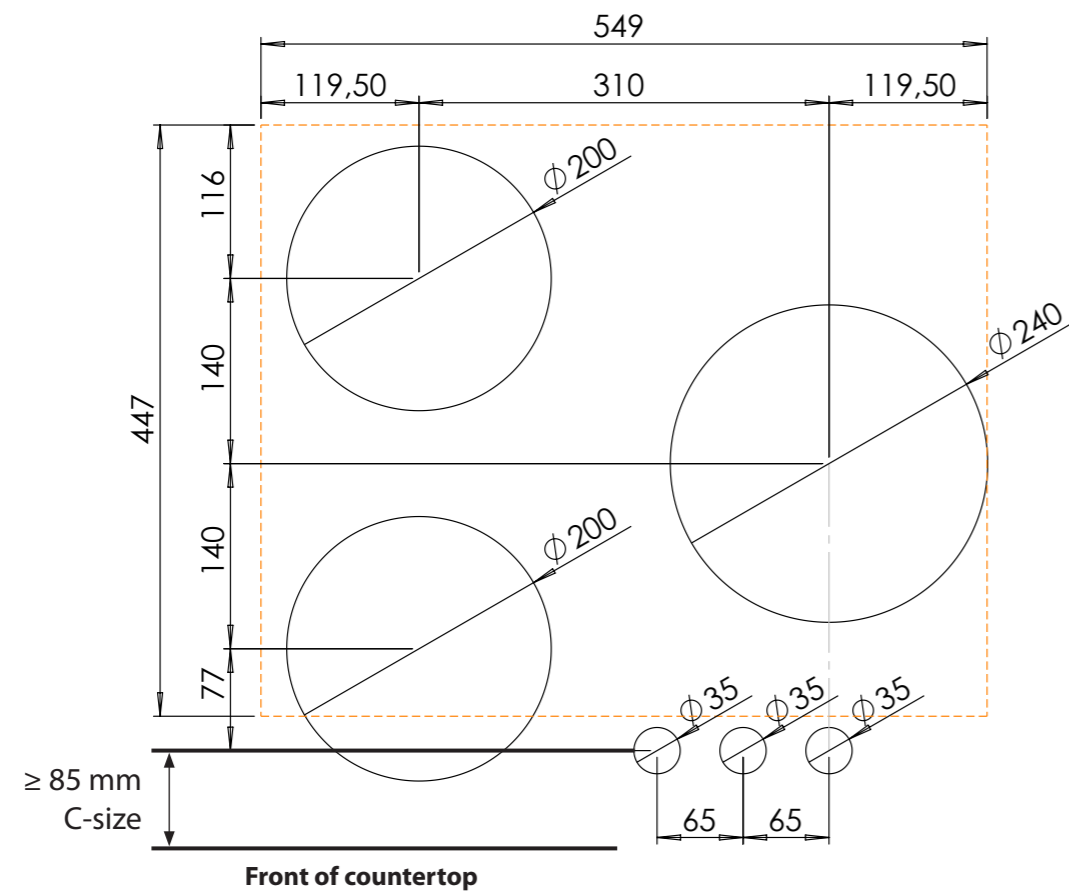

Hole pattern
DXF file

Technical information



Model	Capital Top Side
Type zones	2x zone small, 1x zone large
Editions	Black (fully black)
Automatic pan detection	✓
Power levels	0 - 10 + Boost
Nominal voltage 1	220-240 V, 2N~
Nominal voltage 2	380-415 V, 2N~
Maximum power	6680 W
Netto weight	13 kg

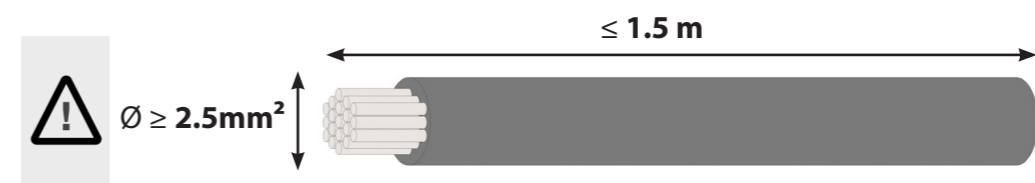
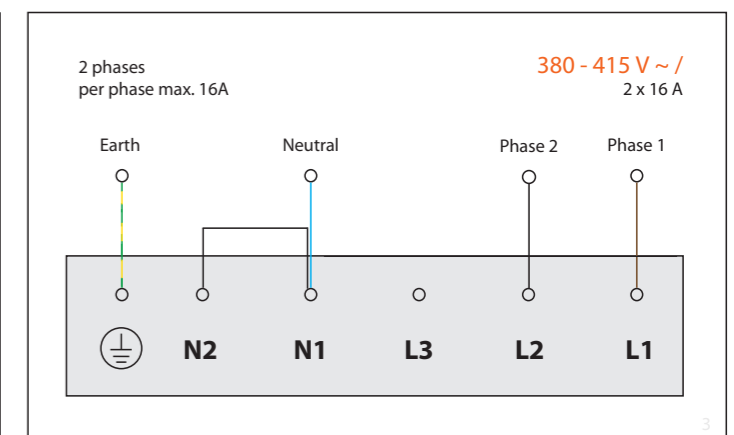
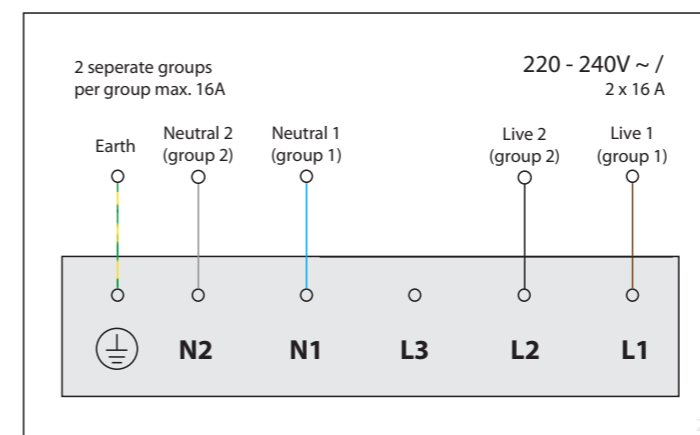



Installation and handling instructions



Installation manual induction



User manual induction

Made in Holland

PITT
COOKING



Induction
Capital-I
Front Side

Exploded view

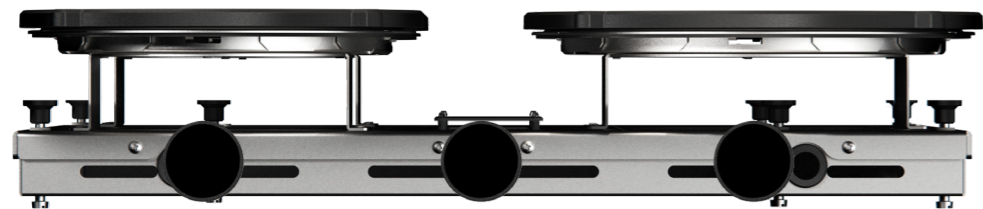

1. **Decorative ring small**
PVD COATED ALUMINUM

2. **Decorative ring large**
PVD COATED ALUMINUM

3. **Induction zone small**
PVD COATED ALUMINUM/ CERAMIC GLASS

4. **Induction zone large**
PVD COATED ALUMINUM/ CERAMIC GLASS

5. **Control knob**
ALUMINUM/GLASS

6. **Cassette**
ALUMINUM

Induction zones

Small zone

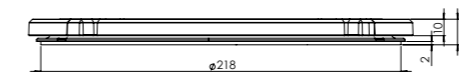
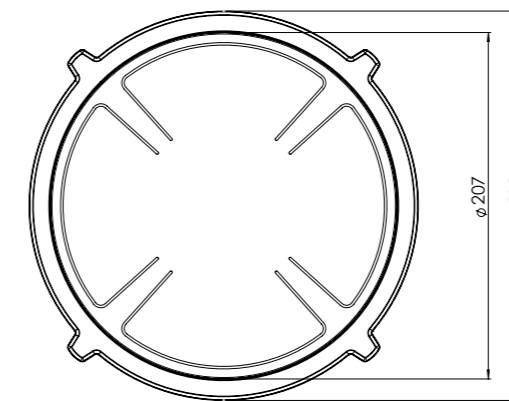

SMALL ZONE

NOM. POWER

1400 Watt

MIN. DIAM. PAN

110 mm

MAX. POWER

2100 Watt

MAX. DIAM. PAN

210 mm

Large zone

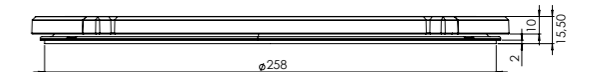
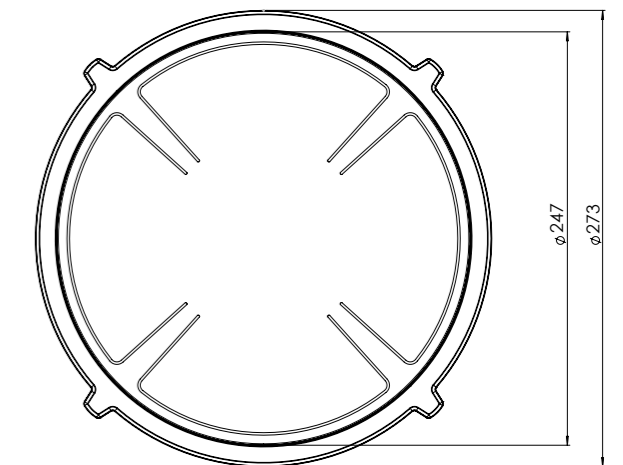

LARGE ZONE

NOM. POWER

2300 Watt

MIN. DIAM. PAN

110 mm

MAX. POWER

3000 Watt

MAX. DIAM. PAN

250 mm

Control knob

3D-visualization of Top Side knob



3D-visualization Front Side knob



Dimensions control knob

Front view

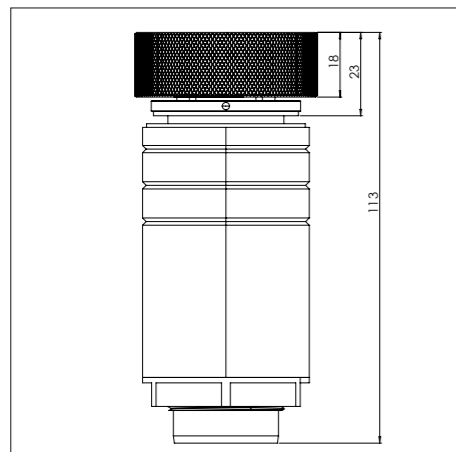

Top view

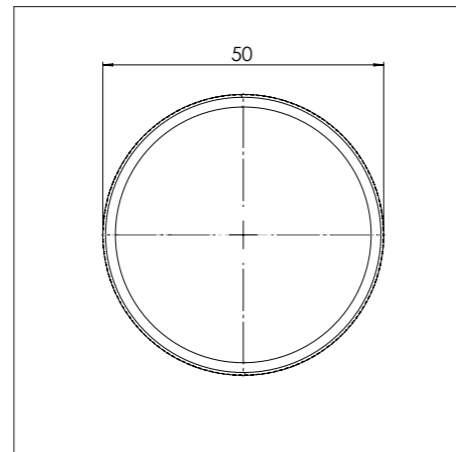

Control knob

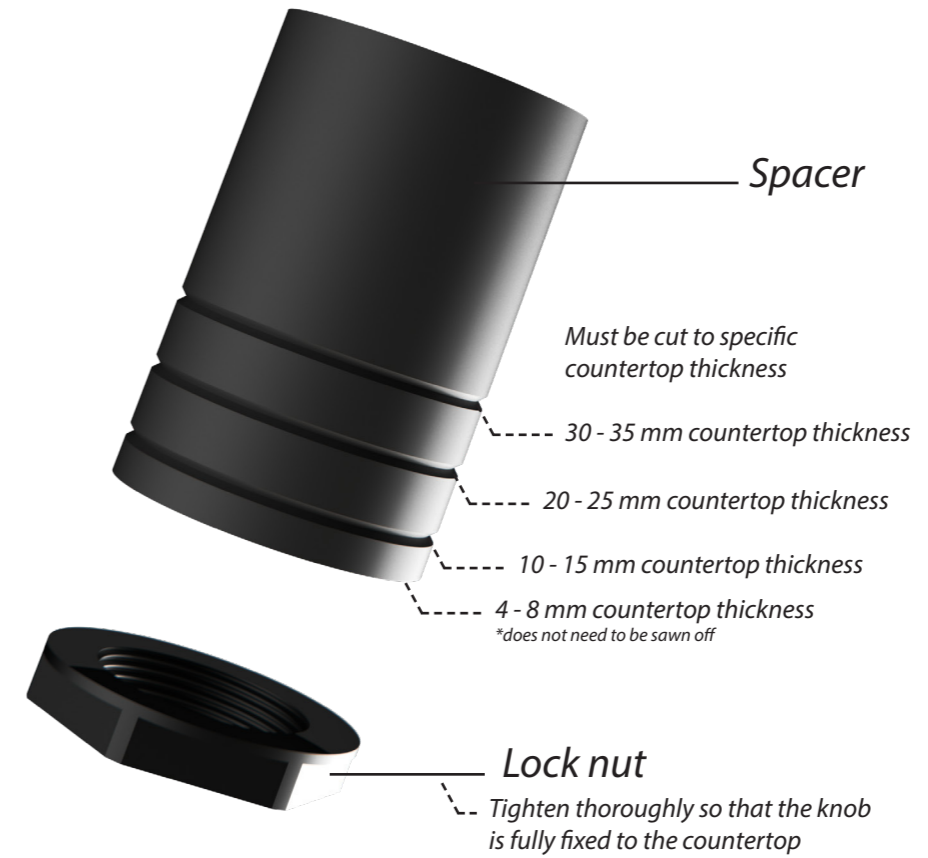
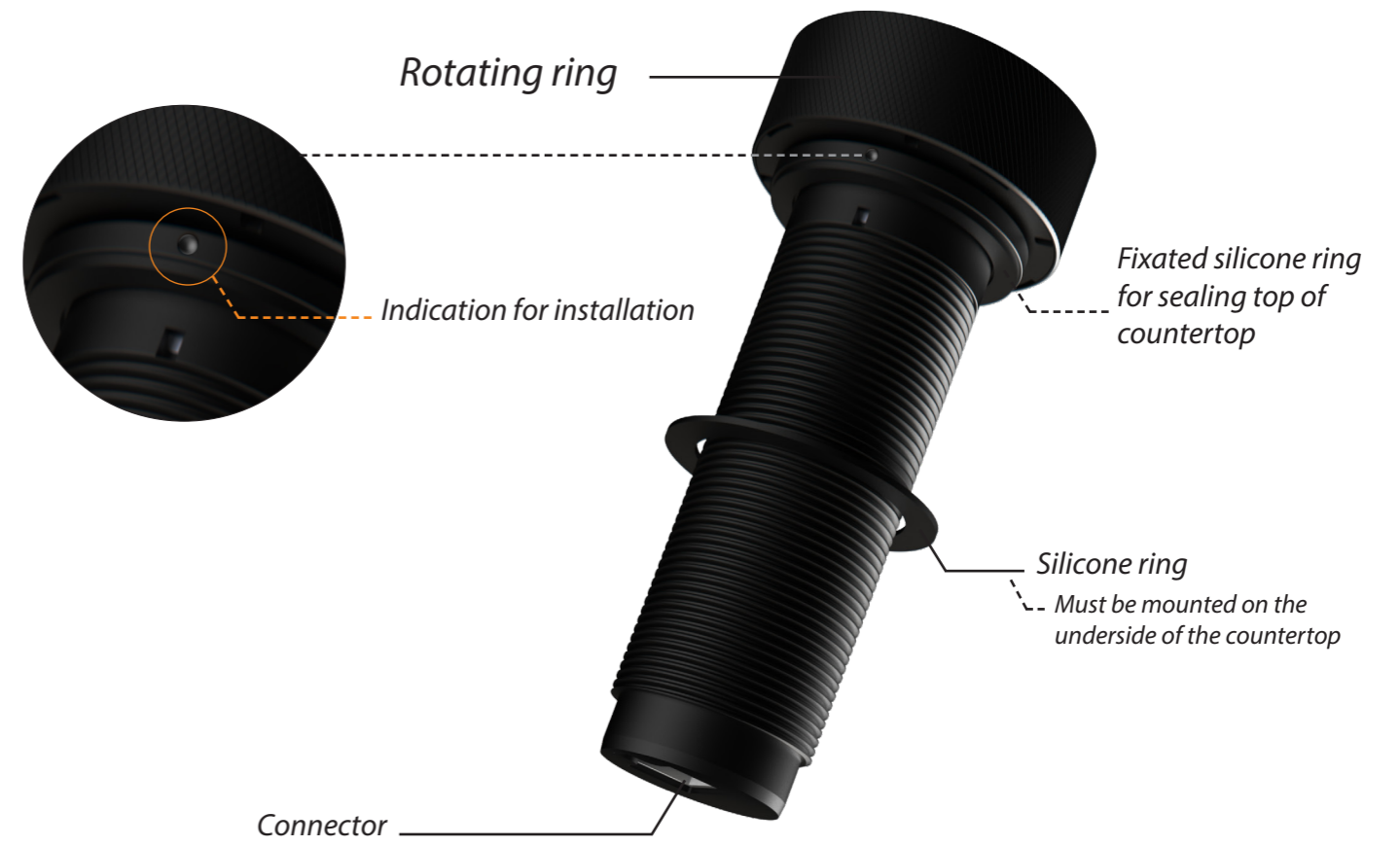

Technical drawing

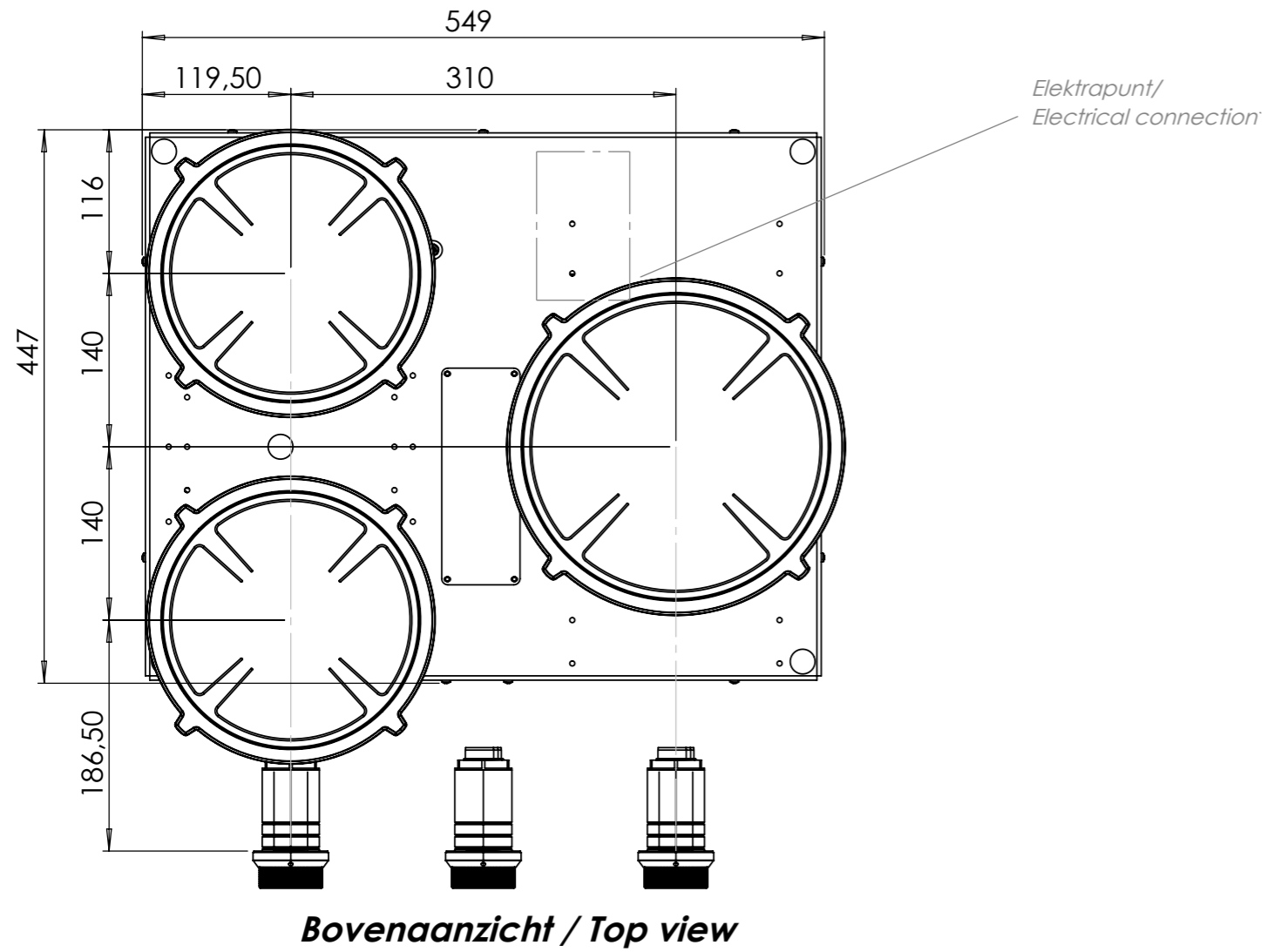

Technical drawing

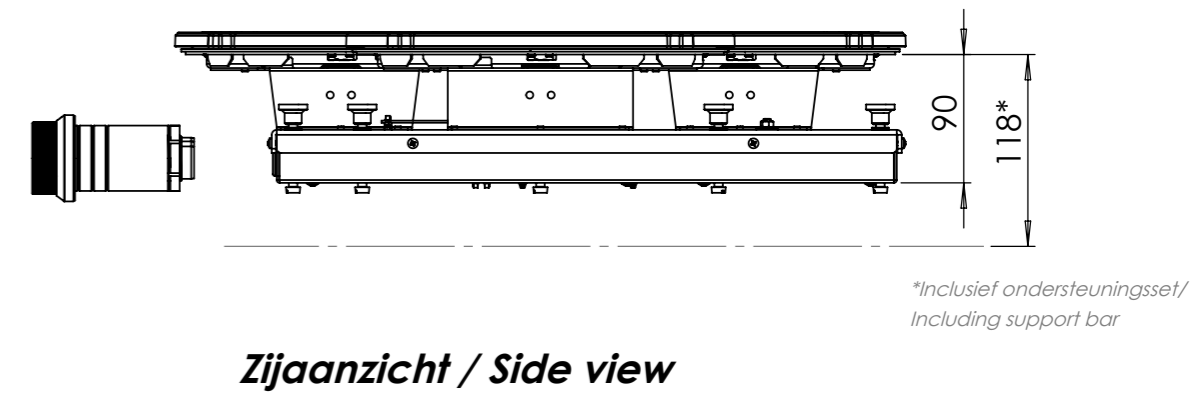
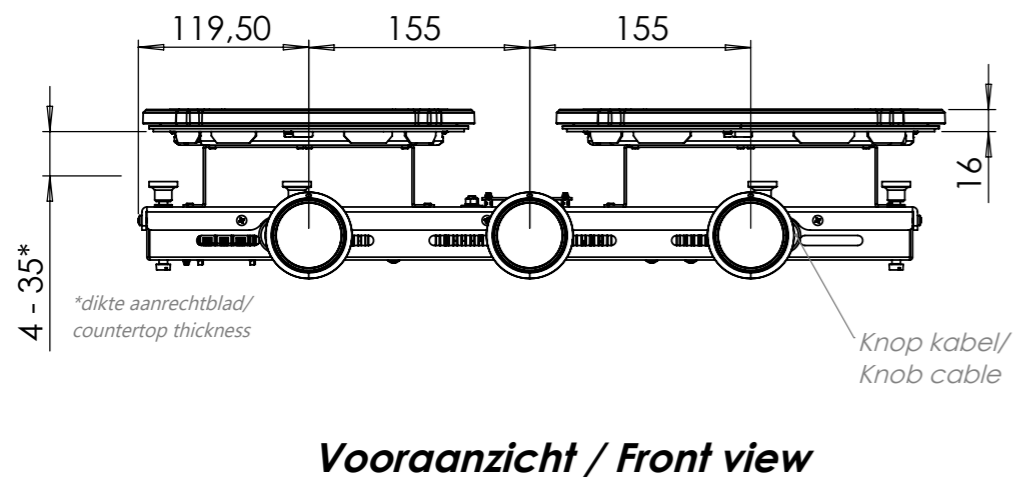
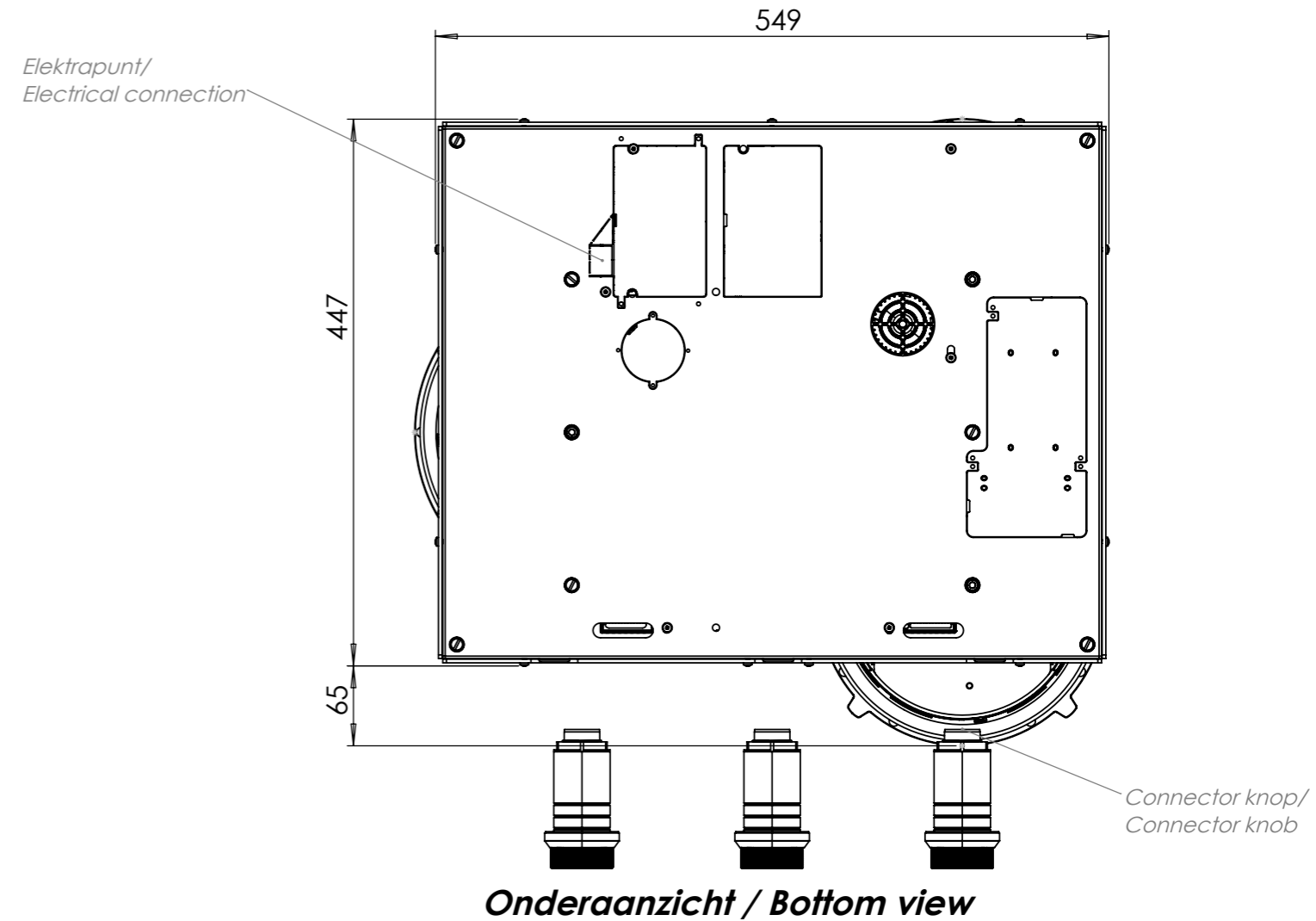

Hole pattern

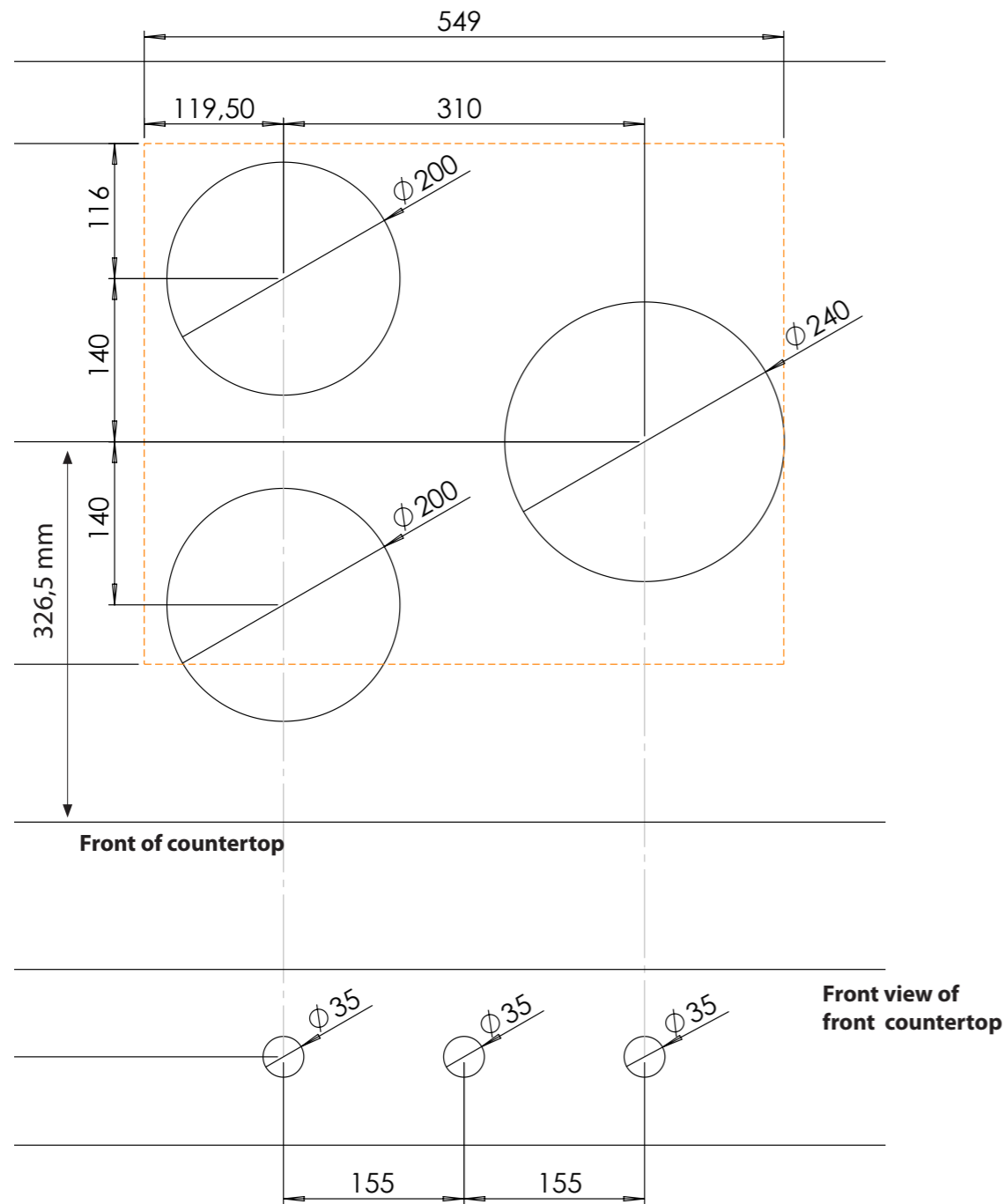

Hole pattern
DXF file

Technical information

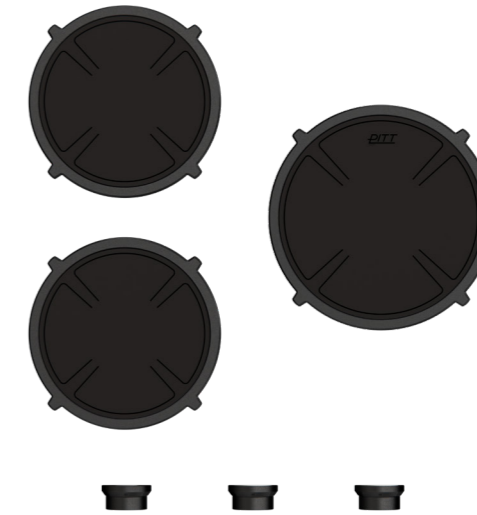

Model	Capital Front Side
Type zones	2x zone small, 1x zone large
Editions	Black (fully black)
Automatic pan detection	✓
Power levels	0 - 10 + Boost
Nominal voltage 1	220-240 V, 2N~
Nominal voltage 2	380-415 V, 2N~
Maximum power	6680 W
Netto weight	13 kg

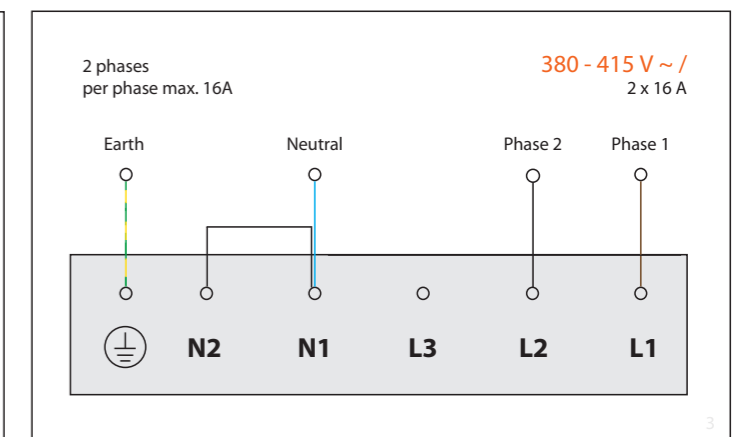
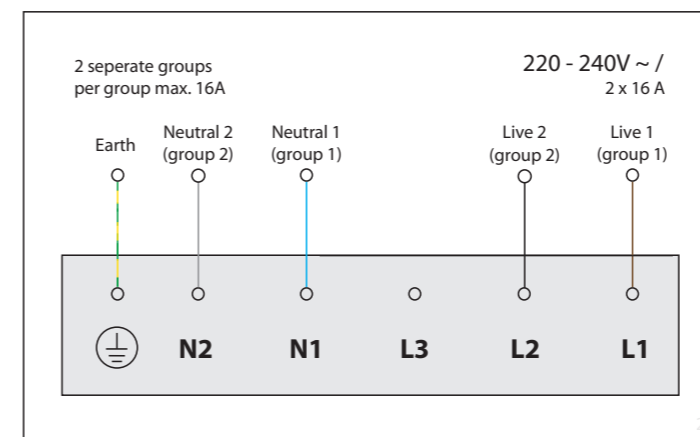

$\varnothing \geq 2.5\text{mm}^2$





Installation and handling instructions



Installation manual induction



User manual induction